



Welcome to  
**greenest**  
*One*

where  
luxury meets  
sustainability in  
perfect harmony.  
Nestled in the heart of  
Thiruvananthapuram, our  
villas offer an unmatched  
blend of modern comfort and  
eco-conscious living. Discover  
the epitome of serene,  
sustainable living at  
Greenest ONE.

EXPERIENCE  
LUXURY,  
EMBRACE  
SUSTAINABILITY



TRANSFORM YOUR  
DAILY ROUTINE INTO  
A WEEKEND  
**GETAWAY**

Escape the ordinary and immerse yourself in the extraordinary at Greenest ONE. Our luxury villas redefine everyday living, offering a seamless blend of comfort and sustainability. Experience the serenity of a weekend retreat every day.

**Welcome to your new sanctuary.**





# Welcome to greenest One

where luxury and sustainability intertwine to create an exclusive living experience. Discover the essence of elegant resort living blended with a profound commitment to community and green practices. In a city where space is a rare luxury, Greenest ONE offers an abundance of tranquility and serenity amidst beautifully landscaped gardens. Immerse yourself in the lush surroundings, where every corner exudes peace and harmony. Our meticulously crafted interiors provide a sanctuary for cherished moments and everlasting memories. Experience the epitome of sustainable luxury, where your well-being and the planet's health go hand in hand.

# MORE THAN A HOME



## EXPERIENCE OUR AMENITIES

Discover a realm of comfort and convenience at Greenest one, where every amenity is tailored to elevate your stay to unparalleled heights of relaxation and enjoyment.



### RESORT LIVING



TREE HOUSE



PANORAMIC VIEW



MIYAWAKI  
FRUIT FOREST



WORK FROM  
NATURE



FULLY EQUIPPED  
CLUB HOUSE



INFINITY POND

### IMPROVED SPACE QUALITY



IGBC GOLD  
CERTIFICATION



BIOPHILIC  
DESIGN APPROACH



EXCELLENT  
DAY LIGHTING



IMPROVED  
AIR QUALITY



SMART  
SECURITY FEATURES



EXTERNAL  
QUALITY ASSURANCE

LOW LIVING COST



100% SOLAR ENERGY



LOW MONTHLY MAINTENANCE CHARGES



EV FAST CHARGING STATION



UPTO 50% WATER USAGE REDUCTION



ENERGY MANAGEMENT SYSTEM



UPTO 30% ENERGY USAGE REDUCTION

SMART SAFETY & SECURITY



CCTV SURVEILLANCE



MOTION & INTRUSIVE ALARMS



BIOMETRIC DIGITAL DOOR LOCK



CO2 SENSOR



GAS LEAK SENSOR



FIRE EXTINGUISHER & FIRE BLANKET

## EXPERIENCE OUR AMENITIES

Embark on a journey of leisure and luxury at greenest one, where a myriad of amenities beckon to create unforgettable moments and cherished memories

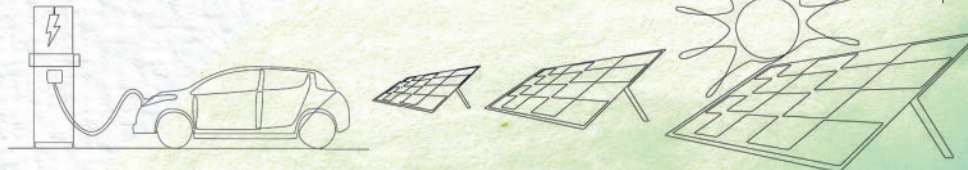

# PLOT LAY OUT



- SWIMMING POOL
- SUNSET DECK
- BADMINTON COURT
- GYMNASIUM
- BANQUET HALL
- LIBRARY
- CRECHE / KIDS ROOM
- SHARED WORKSPACE
- GUEST ROOM

MIAWAKI FRUIT FOREST  
 ▶ MEDITATION ZONE & GARDEN WALKWAY

EV FAST CHARGING STATION

LAND AREA  
**2.1**  
 ACRES

VILLAS  
**29**  
 NOS

3 BHK  
**18**  
 NOS

4 BHK  
**11**  
 NOS

- CHILDREN'S PLAY AREA
- INFINITY POND & DECK
- RECREATIONAL POND & PAVILION
- TREE HOUSE
- WORK FROM NATURE





COMMON  
LAND AREA  
SHARE  
**3.5**  
CENTS

VILLAS (Plof No.)	PLOT AREA (Cents)	VILLA AREA (Sq.ft*)
1 to 4	4.50	2217
5	4.60	2265
6	5.30	2408
7	3.50	1618
8 to 13	3.50	1568
14	3.90	1969
15	3.20	1597
16	3.60	1583
17	3.60	1656
18	3.25	1565
19 to 24	3.25	1486
25	3.25	1501
26	4.60	2579
27	4.40	2499
28	4.31	2428
29	4.70	2497

Villas Area Includes 110 Sqft Club House Area Share

# FLOOR PLANS

LARGE INTERNAL COURTYARD

FUNCTIONAL OPEN PLANNING

ALL ROOMS CROSS VENTILATED

PASSIVE ARCHITECTURAL DESIGN



GROUND FLOOR



FIRST FLOOR

Typical floor plan of 3 BHK (Plot 8 - 13)



“ In our eco-sanctuary, reclaimed wood whispers tales of forests past, while sunbeams caress recycled fabrics, weaving a tapestry of harmony with the Earth

**MORE THAN A HOME**”

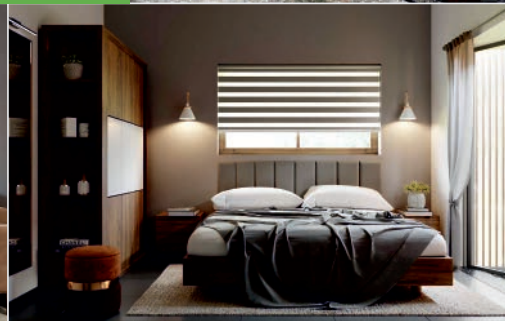
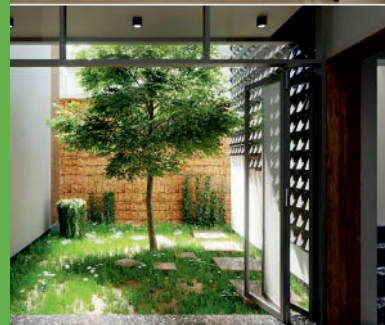

# SPECIFICATION

## STRUCTURE

Cement	: Dalmia green / ultra tech
TMT bars	: TATA Steel
Foundation	: RCC framed structure/ Rubble masonry
Walls	: 8" Cement stabilized Mudblock
Floor slab	: RCC slab 110mm thick
Plastering	: External walls - Cement Plastering Internal walls - Gypsum Plastering

## DOORS & WINDOWS

Main Door	: Teak wood
Door Lock	: Biometric digital door lock Yale / Godrej
Other Door	: Anjili / Jack Tree
Door Lock	: Stainless Steel mortise lock Godrej / Yale
Windows	: Premium aluminium windows Tostem / Fenesta
Window glass	: Saint Gobain / AIS

## SANITARY

Water source	: Bore well + Rain water / KWA
PVC pipes	: Supreme / finolex
CPVC pipes	: Supreme / finolex
CP Fittings	: Jaquar / Grohe - Low flow rate
Sanitary fittings	: Jaquar / Grohe - Low flow rate
EWC	: Wall mount - concealed flush tank
Shower	: Divertor
Dining wash	: Counter top wash basin
Kitchen Sink	: Double bowl sink
Solar Water Heater	: Havells / V- Guard

## FLOORING

Common areas	: Semi glossy vitrified tiles 120 x 80 CM (Somany / kajaria)
Bedrooms	: Laminated wooden flooring Green / Action TESA
Kitchen	: Matt finish vitrified tiles 60 x 60 CM (Somany / Kajaria)
Toilets	: Matt finish vitrified tiles 60 x 60 CM (Somany / Kajaria)
Kitchen counter	: Nano white crystallized glass (AGL)
Stairs	: Lappato finish granite, 20 mm thick

## ELECTRICAL

Solar Panel	: On - grid system
Conduit pipes	: Balcon
Wiring	: RR green / Havells
Switches	: Legrand Lyncus / Myrius
DB	: Legrand 3 phase

## PAINTING

Puffy	: Jotun
Internal walls	: Jotun phenomastic emulsion
External walls	: Jotun jotashield extreme
Iron Members	: Jotun enamel
Wooden members	: MRF wood coat exterior polish



100%  
TREATED WATER



AUTOMATED  
STREET LIGHTING



FTTH  
FIBRE TO THE HOME



DG BACKUP FOR  
COMMON AREAS



AUTOMATED  
WATERING



WATER PROOFING &  
TERMITE TREATMENT



----- CHILDREN'S HEAVEN -----



DEDICATED CHILDREN'S PLAY AREA



CRECHE FOR TODDLERS



KIDS POOL



CHILDREN'S LIBRARY



PLUCK FRESH FRUITS FROM FRUIT FOREST



LIVE IN HARMONY WITH NATURE



----- ELDERS PARADISE -----



ALL AROUND JOGGING TRACK



PANORAMIC SUNRISE & SUNSET



GYMNASIUM & SWIMMING POOL



LUSH SITTING AREAS



DEDICATED BADMINTON COURT



MINI HALL & LIBRARY



# DISTANCE FROM ONE

Sabarigiri Int. School	- 1.4 Km
Mannanthala	- 4.7 Km
Sreekaryam	- 5.3 Km
Technopark	- 7.5 Km
College of Engg. TVM	- 6.8 Km
Pothencode	- 5.8 Km
Medical College	- 8.8 Km
Lulu Mall	- 12.4 Km
International Airport	- 13.8 Km

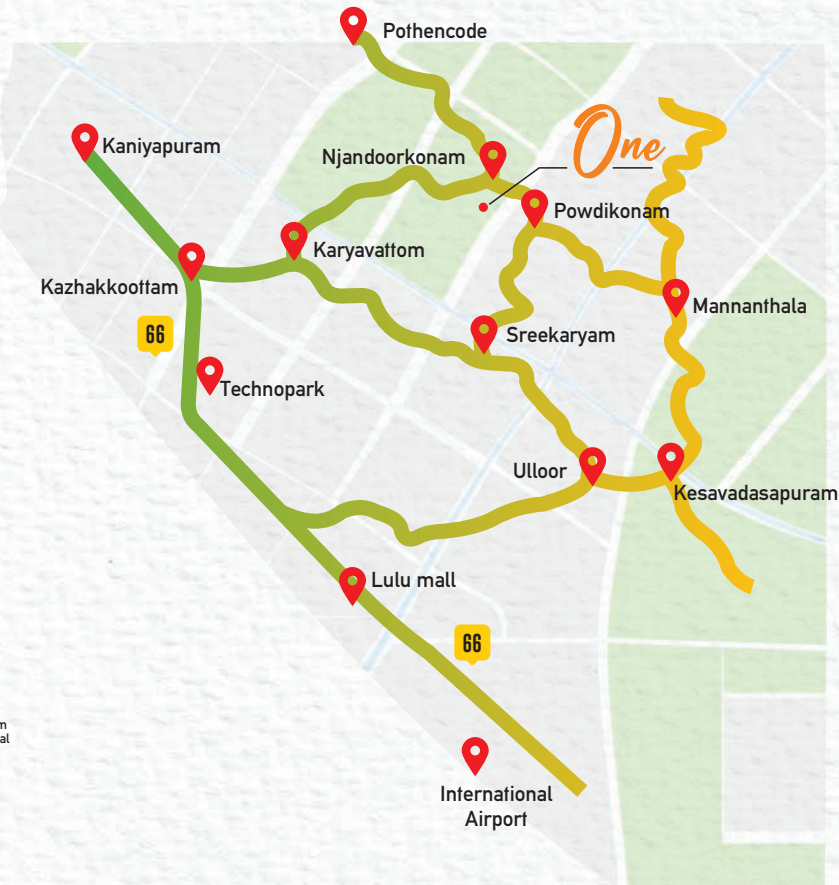

# TIME TO DRIVE (In MINUTES)

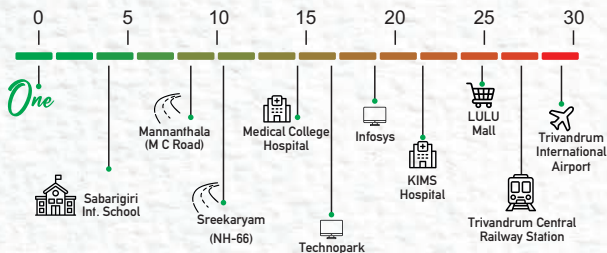



“ Nestled among verdant hills, our Greenest one's eco-friendly ethos blooms in every corner, where native flora dances with the breeze and solar panels hum in harmony with the sun's radiant embrace.

MORE THAN A HOME”





WATCH WALK  
THROUGH



VISIT WEBSITE



📍 Greenest Buildings & Business Pvt. Ltd,  
Nandavanam, Trivandrum - 695 033

🌐 [www.greenest.co.in](http://www.greenest.co.in)

✉ [mail@greenest.co.in](mailto:mail@greenest.co.in)

📞 0471 2991231. 8078079111



\*All the images shown are for illustration purpose only and may not be an exact representation of the space